

Pitts21[®]



3D CONTROL HAS ARRIVED



orthodontics
Finish with the Best

Pitts21®

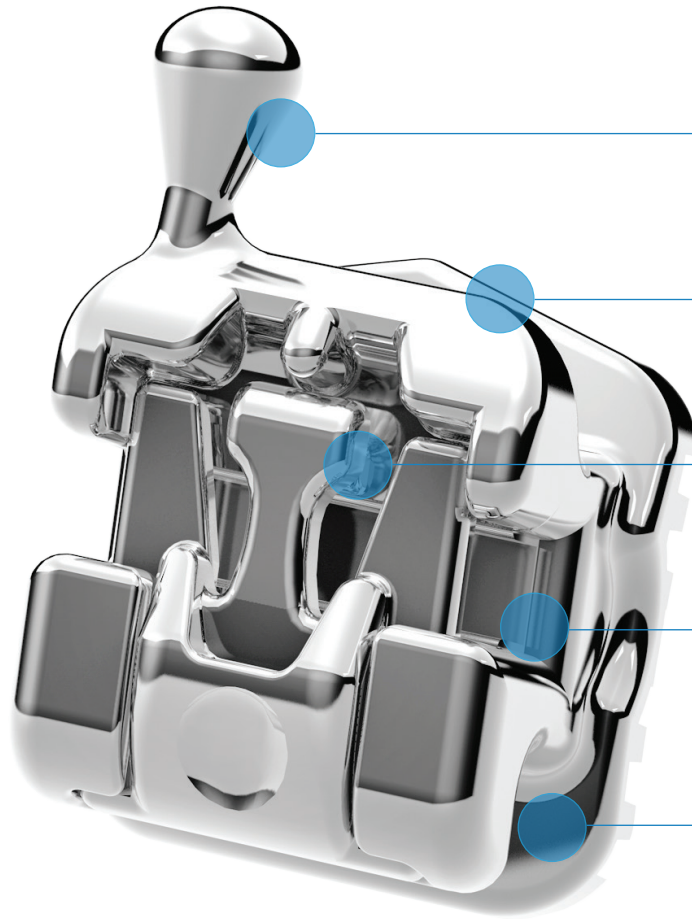

The Science of the Pitts21 Door

Designed for enhanced stability and control.

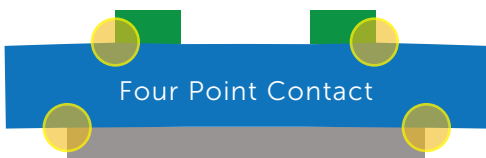

■ Door ■ Wire ■ Bracket Body

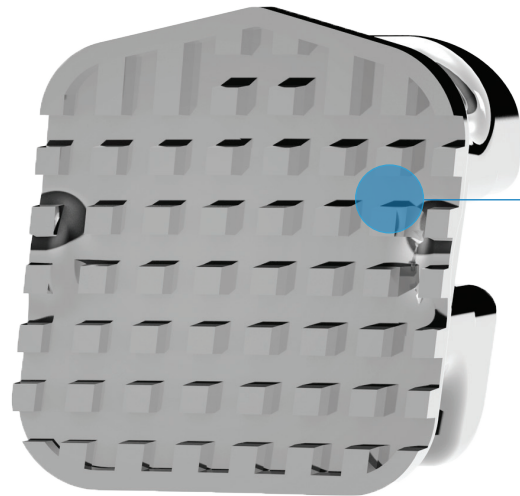

Integrated Hooks

An available option on the 3's, 4's and 5's for your convenience at no extra charge.

Smooth, Rounded Edges

Ensures that your patients have the most comfortable experience.

Unique Door Design

The unique sliding door is designed to create improved control of rotation and torque, while providing enhanced structural stability.

.021 Precision Slot Depth

The reduced slot depth is designed to provide a tighter pairing between the wire and the bracket leading to earlier engagement, improved torque, and better control.

Large Under Tie-Wing Clearance

Supports early elastics, ligatures, metal ligatures, and power chain.

Base Lock Plus

One piece base/bracket aims to create an optimum pad-to-tooth fit and bond strength resulting in fewer broken brackets and fewer debonding issues.

Square Wire Finishing

Provides you with unparalleled 3D control earlier and throughout treatment.



Photo courtesy of Dr. Lili Ivashkevich

Pitts21®

- First and only self-ligating system that aims to provide **3D control** earlier and throughout treatment.
- Revolutionary **square wire finishing** uses 30-40% lighter forces* with greater control, comfort, and sliding mechanics.
- **Progressive slot** aims to provide an intelligent balance of control and freedom of movement to provide effective sliding mechanics.
- **Predictable finishes** in as few as 4 wires.

**Horizontal and vertical forces; compared to rectangular systems*

Progressive Slot Depth Delivers 3D Control

The patent pending Pitts21 system progressively varies the slot from square in the anterior to rectangular in the posterior portion of the arch. This aims to provide exceptional control of the anterior teeth while allowing for increased freedom of movement on the posterior teeth.

Slot depth, from buccal to lingual.

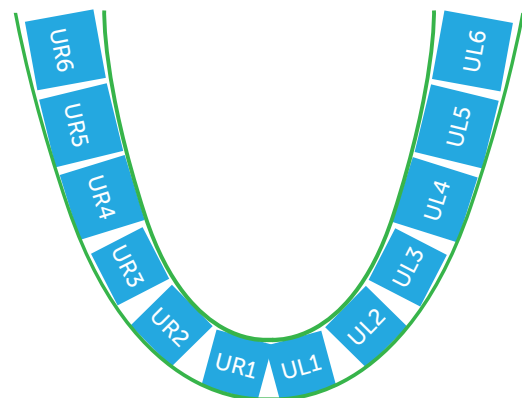

Square Wire Finishing

Torque Control

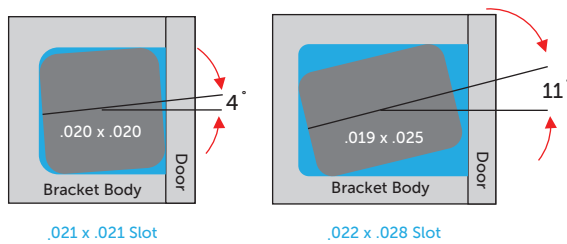

Tip Control

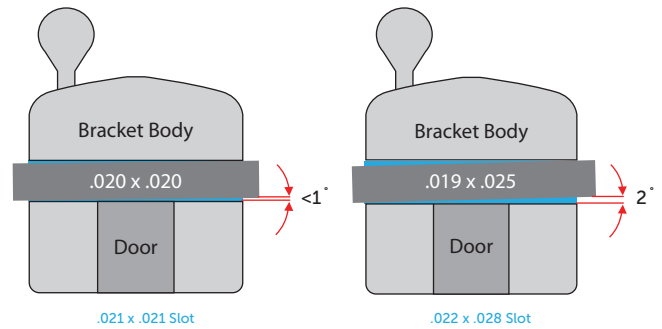

Rotation Control

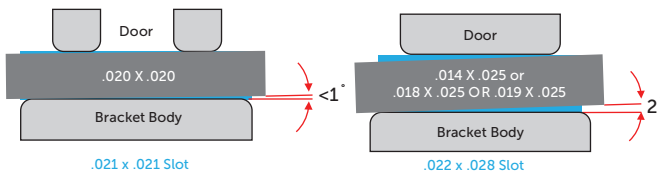

On the social six, Pitts21 catches a couple **64% sooner** than a rectangular system, while also **reducing play by 70%**. All with **30-40% lighter forces**, providing you with precise, comfortable 3D control earlier and throughout treatment.

Powerful Benefits

Designed to Reduce Treatment Time

Improved early 3D control of torque, tip and rotation aims to reduce treatment time

Remarkable Patient Comfort

Square wire finishing uses 30-40% lighter forces* with greater control than traditional rectangular wire

Efficient Tooth Movement

True 3D control in as few as 4 wires promotes efficient tooth movement

Stunning Smiles

Pitts active early protocols enable you to create the most stunning smiles

*Horizontal and vertical forces; compared to rectangular systems



Pitts21® Outperforms Rectangular

In the charts below you can see the impact of Pitts21®. Pitts21® catches a couple sooner when compared to a rectangular archwire system. In addition to catching a couple sooner and finishing in as few as 4 wires, Pitts21® aims to deliver more precise 3D movement while using lighter forces than other rectangular systems. A quicker couple, with decisive control - Pitts21®.

Pitts21® Square Wire Treatment vs. Rectangular Wire Treatment

Pitts21® Square Wire Treatment - .021 x .021								
Phase	Initial		Working			Finishing		
Wire	.014 Thermal Activated Nickel Titanium		.018 x .018 Ultra-Soft Thermal Activated Nickel Titanium		.020 x .020 Thermal Activated Nickel Titanium		.020 x .020 Beta Titanium or Stainless Steel	
Torque	No Control		14.2°	51% Sooner	4.2°	70% Sooner	4.2°	62% Sooner
Rotation	4.5°	47% Sooner	1.9°	Same	0.6°	65% Sooner	0.6°	65% Sooner
Tip	3.8°	11% Sooner	1.9°	55% Sooner	0.6°	74% Sooner	0.6°	66% Sooner

Compared To	Rectangular Archwire Treatment - .022 x .028						
Phase	Initial		Working			Finishing	
Wire	.014 Nickel Titanium	.018 Nickel Titanium	.014 x .025 Nickel Titanium		.018 x .025 Nickel Titanium		.019 x .025 Stainless Steel
Torque	No Control	No Control	28.8°		13.8°		10.9°
Rotation	8.5°	6.1°	1.9°		1.9°		1.9°
Tip	4.3°	2.2°	4.3°		2.2°		1.6°

*Charts based on anterior teeth (cuspid to cuspid) with minimal A/P discrepancy

Pitts21® Catches a Couple Sooner!

As Few as Four Wires From Start to Finish

With the Pitts21® system you will use as few as four wire change appointments from start to finish. Fewer wires means fewer appointments for your patients, saving you time and money.

Phase	Initial	Working		Finishing	Optional Archwires	
Wire	.014 Thermal Activated Nickel Titanium	.018 x .018 Ultra-Soft Thermal Activated Nickel Titanium	.020 x .020 (Upper) Thermal Activated Nickel Titanium	.020 x .020 Beta Titanium (Upper)	.019 x .019 Stainless Steel	.020 x .020 Stainless Steel
			.019 x .019 (Lower) Thermal Activated Nickel Titanium	.019 x .019 Beta Titanium (Lower)	Extraction Cases	Extra Width

We offer you a variety of archwires to complement the Pitts21® bracket and deliver the torque and control you need with square wire finishing. The Pitts21® Broad archwires have been meticulously designed to reduce extractions while achieving torsion even earlier meaning you can finish cases faster.

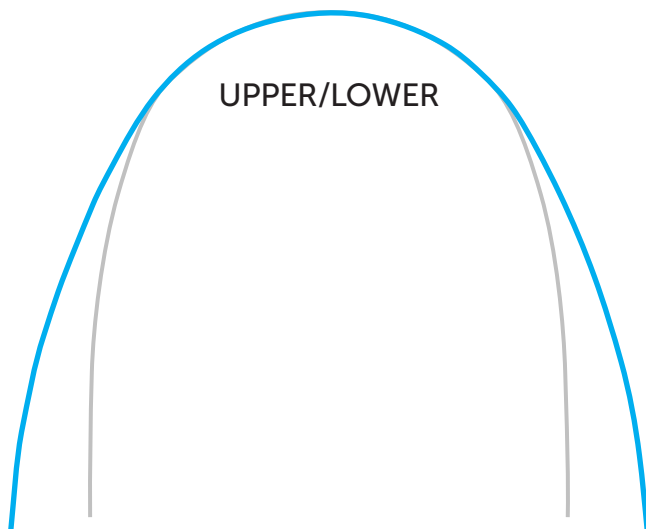

PITTS21 BROAD ARCHFORM
compared to **NATURAL ARCHFORM**

Diagrams represent typical arch shapes. Actual sizes may vary slightly.

"I had the opportunity to test the Pitts21 bracket system, which included the recommended archwire sequence. I was amazed in what I experienced which included faster and greater control with both rotation and torque and with lighter forces. Even though the sample size was limited, based upon what I experienced, I believe Pitts21 is a powerful precision appliance system with previously unknown control."

James Morrish D.D.S.
Morrish Stewart Orthodontics

Single Prescription Inventory

Unlike other bracket systems, the versatile Pitts21® System is a single prescription for all patients. Without the need for a variable bracket inventory, you can simplify processes for your staff while reducing your bracket inventory, saving you both time and money.

.021" x .024" slot		.021" x .023" slot		.021" x .021" slot		
-27° torque +9° offset	-27° torque -22° torque +9° offset	-11° torque +2° angle 2.80mm M/D		+9° torque +5° angle 3.05mm M/D	+6° torque +9° angle 2.54mm M/D	+12° torque +5° angle 3.05mm M/D
2nd Molar (UR7/UR6) P21 Buccal Tube w/ Gingival Hook 947.2101	1st Molar (UR6) P21 Buccal Tube w/ Gingival Hook 947.2101 (-27) ● 947.2099 (-22) ●	Bicuspid (UR4/5) w/ Distal Hook 946.2011		Cuspid (UR3) w/ Distal Hook 946.2007	Lateral (UR2) No Hook 946.2003	Central (UR1) No Hook 946.2001

Right

Right

2nd Molar (LR7) P21 Buccal Tube w/ Gingival Hook 947.2107	1st Molar (LR6) P21 Buccal Tube w/ Gingival Hook 947.2107	2nd Bicuspid (LR5) w/ Distal Hook 946.2024	1st Bicuspid (LR4) w/ Distal Hook 946.2020	Cuspid (LR3) w/ Distal Hook 946.2016	Anterior (L1/2) No Hook 946.2013	
+3° offset -22° torque	+3° offset -22° torque	2.80mm M/D +2° angle -17° torque	2.80mm M/D +2° angle -12° torque	3.05mm M/D +5° angle +9° torque	2.54mm M/D 0° angle -6° torque	
.021" x .024" slot		.021" x .023" slot		.021" x .021" slot		

5x5 Case

(20 Brackets)

Hooks on 3's, 4's, & 5's

#946.2032

7x7 Case (-22 U6's)

(20 Brackets & 8 Buccal Tubes)

Hooks on 3's, 4's, & 5's

#946.2155

7x7 Case - Lower

(10 Brackets & 4 Buccal Tubes)

Hooks on 3's, 4's, & 5's

#946.2151

7x7 Case - Uppers

(10 Brackets & 4 Buccal Tubes)

Hooks on 3's, 4's, & 5's

#946.2152

7x7 Case (-27 U6's)

(20 Brackets & 8 Buccal Tubes, -27 U6's)

Hooks on 3's, 4's, & 5's

#946.2080

.021" x .021" slot			.021" x .023" slot		.021" x .024" slot	
+12° torque +5° angle 3.05mm M/D	+6° torque +9° angle 2.54mm M/D	+9° torque +5° angle 3.05mm M/D	-11° torque +2° angle 2.80mm M/D		-27° torque -22° torque +9° offset	-27° torque +9° offset
Central (UL1) No Hook 946.2002	Lateral (UL2) No Hook 946.2004	Cuspid (UL3) w/ Distal Hook 946.2008	Bicuspid (UL4/5) w/ Distal Hook 946.2012		1st Molar (UL6) P21 Buccal Tube w/ Gingival Hook 947.2102 (-27) ● 947.2100 (-22) ●	2nd Molar (UL7/UL6) P21 Buccal Tube w/ Gingival Hook 947.2102

Left

Left

.021" x .021" slot		.021" x .023" slot			.021" x .024" slot	
2.54mm M/D 0° angle -6° torque		3.05mm M/D +5° angle +9° torque	2.80mm M/D +2° angle -12° torque	2.80mm M/D +2° angle -17° torque	+3° offset -22° torque	+3° offset -22° torque
Anterior (L1/2) No Hook 946.2013		Cuspid (LL3) w/ Distal Hook 946.2017	1st Bicuspid (LL4) w/ Distal Hook 946.2021	2nd Bicuspid (LL5) w/ Distal Hook 946.2025	1st Molar (LL6) P21 Buccal Tube w/ Gingival Hook 947.2108	2nd Molar (LL7) P21 Buccal Tube w/ Gingival Hook 947.2108

Initial



Initial Bonding



Actual Patient of Dr. Tom Pitts
Photos taken throughout treatment by:
Ortho Country Orthodontics

Additional Pitts21 Products

Pitts21® 5-Case Starter Kit

We want you to experience the difference of the Pitts21 system yourself with our Pitts21 starter kit. Our starter kit includes: 5 Full Sets (7x7) of Pitts21 brackets and buccal tubes, (5) Sets of Pitts21 Broad Archwires (5 upper and 5 lower of each set), Pitts21 Tool, Angled Self-Locking Bracket Tweezer, SAP Ruler, USB Flash Drive, and Pitts21 Kit Brochure.



#946.2150

Finish

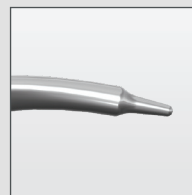

The H4/Pitts21 Tool is an excellent opening and closing instrument for all Pitts21 brackets. The sloped tip provides a comfortable angle for opening and closing bracket doors.

#916.0100

The Director Tool swiftly opens the Pitts21 doors. It also helps direct wires for removal and placement.

#916.0101

A transformational new self-ligating bracket system that delivers 3D control for fast and more precise finishes.

"As a practicing orthodontist and as a Pitts 21 patient, I can see firsthand the advantages of a square bracket slot. The control, speed and torque control were vastly superior as compared to my mini-twin bracket patients."

Jeff Haskins D.D.S., M.S., P.C.

Village Orthodontics

Thomas Pitts D.D.S., M.S.D.

Dr. Tom Pitts is a world renowned leader in esthetic orthodontics and is highly recognized for his teaching on orthodontic finishing and clinical excellence. Dr. Pitts is most known for his innovative protocols and creation of the Smile Arc Protection. He has a variety of clinical publications and has been an active lecturer since 1986. He is also an associate clinical professor at the University of Nevada, Las Vegas. Dr. Pitts currently practices at Ortho Country Orthodontics, OC's on-site orthodontic clinic.

Ready to finish with the best?

Call us today or visit our website.

(866) 752-0065 | www.oc-orthodontics.com



orthodontics

OC Orthodontics

1300 NE Alpha Dr.
McMinnville, OR 97128 USA

BRACKETS MADE IN
USA

©2020 All Rights Reserved OC Orthodontics Rev. H